



Book Shelf

Materials Needed:

- 1 piece of $\frac{3}{8}'' \times 40'' \times 41\frac{1}{2}''$ interior plywood for back (A)
- 2 pieces of $\frac{3}{4}'' \times 15\frac{3}{8}'' \times 41''$ interior plywood for sides (B)
- 1 piece of $\frac{3}{4}'' \times 10'' \times 40\frac{1}{2}''$ interior plywood for shelf (C)
- 1 piece of $\frac{3}{4}'' \times 12\frac{1}{2}'' \times 40\frac{1}{2}''$ interior plywood for shelf (D)
- 1 piece of $\frac{3}{4}'' \times 15'' \times 42''$ interior plywood for bottom (E)
- 4 pieces of lumber 2x2 (actual size $1\frac{1}{2}'' \times 1\frac{1}{2}''$) $\times 7''$ for legs (F)
- 1 piece of lumber 1x2 (actual size $\frac{3}{4}'' \times 1\frac{1}{2}''$) $\times 29''$ for rail (G)
- 2 pieces of lumber 1x2 (actual size $\frac{3}{4}'' \times 1\frac{1}{2}''$) $\times 9''$ for rails (H)
- 8 12d finishing nails
- 6d finishing nails
- Glue
- Wood filler

Tools needed

- Saw
- Hammer
- File
- Nail set
- Sandpaper
- Stain and varnish

Instructions

1. Cut pieces to size. Round front top corners of side pieces with file.
2. Glue and nail shelves (C, D) and bottom (E) to one end piece (B). Note: Wood dowels may be used in place of nails.
3. Glue and nail other end (B) piece to shelves and bottom.
4. Glue and nail back (A) in place.
5. Glue and nail legs (F) to rails (H) using two 12d nails per leg.
6. Glue and nail end/leg unit to each end of rail (G).
7. Set shelf unit on stand unit and glue and nail in place.
8. Sand and finish.

Note: An optional way to join the rail/leg assembly and put the shelving in is to use dowel pins (see circled diagram).

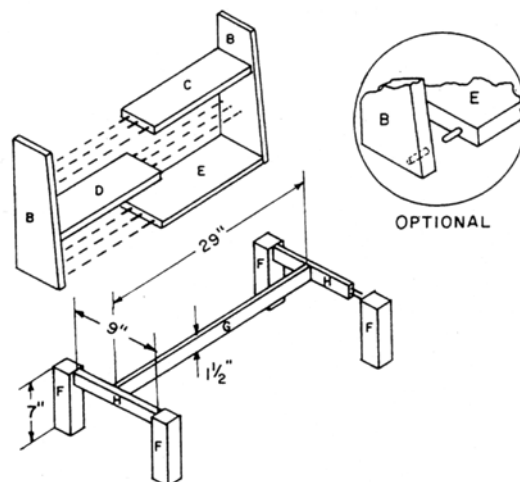
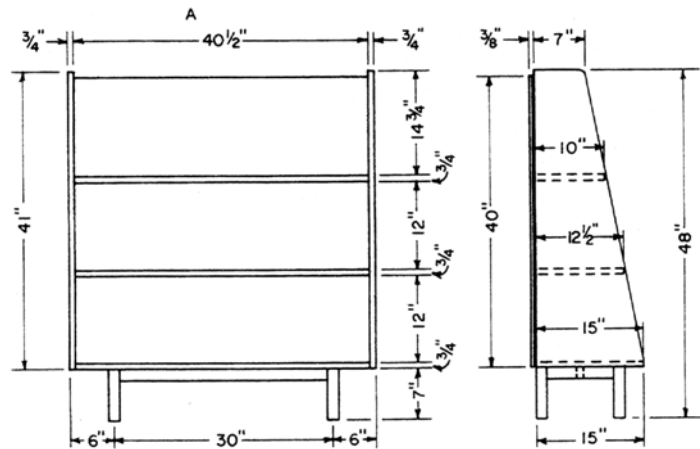
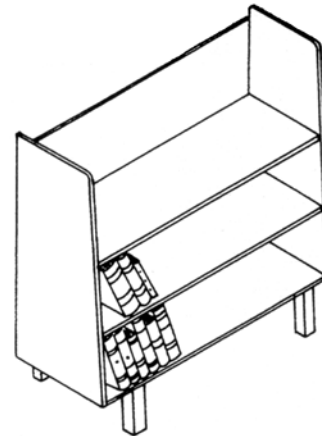



Revolving Tie Rack

Materials needed

- 1 piece of lumber 1×4 (actual size $\frac{3}{4}$ " × $3\frac{1}{2}$ ") × 20" for back
- 1 piece of lumber $\frac{3}{4}$ " × $\frac{3}{4}$ " × 18" for bar
- 3 pieces of lumber 1×2 (actual size $\frac{3}{4}$ " × $1\frac{1}{2}$ ") × $1\frac{1}{2}$ " for hook holders
- 3 pieces of lumber $\frac{3}{4}$ " × $\frac{3}{4}$ " × $1\frac{1}{2}$ " for spacers
- 4 pieces $\frac{1}{4}$ " dowel stock, $3\frac{1}{2}$ " long
- 24 metal screw hooks, $3\frac{1}{2}$ " long
- 3 No. 8 roundhead woodscrews 2" long
- 6 washers for No. 8 screws
- Glue

Tools needed

- Drill press or drill with stop gauge and $\frac{1}{4}$ ", $\frac{1}{8}$ ", and $\frac{1}{32}$ " bits
- Screwdriver
- Sandpaper
- Stain and varnish

Instructions

1. Cut pieces to size.
2. Drill $\frac{1}{4}$ " holes in bar, $\frac{1}{2}$ " deep. Use drill press or drill with stop gauge for uniform depth holes.
3. Drill $\frac{1}{4}$ " holes in back.
4. Drill $\frac{1}{32}$ " pilot holes for screws in the bottom of bar.
5. Drill $\frac{1}{8}$ " mounting holes in back, 4" in from ends and 1" from top edge.
6. Center spacers on hook holders and glue in place.
7. Drill a hole through the center of each holder for the No. 8 screw. Holder should turn free on screw.
8. Sand all pieces.
9. Drill pilot holes in holders for hooks, install hooks leaving them protruding about $1\frac{5}{8}$ ".
10. Mount the bar to the back using the four dowels. Be sure holes for screws are on bottom side of bar.
11. Attach holders to the bar by putting a screw with a washer up through each holder/spacer, put the other washer on, and screw into hole so it will still turn.
12. Apply finish.

